



Marine Debris Tracker

Powered by Morgan Stanley



New Materials Institute
UNIVERSITY OF GEORGIA





3 Million



What is Debris Tracker?

Getting Started with Debris Tracker

debristracker.org

Sara M. Sturgeon

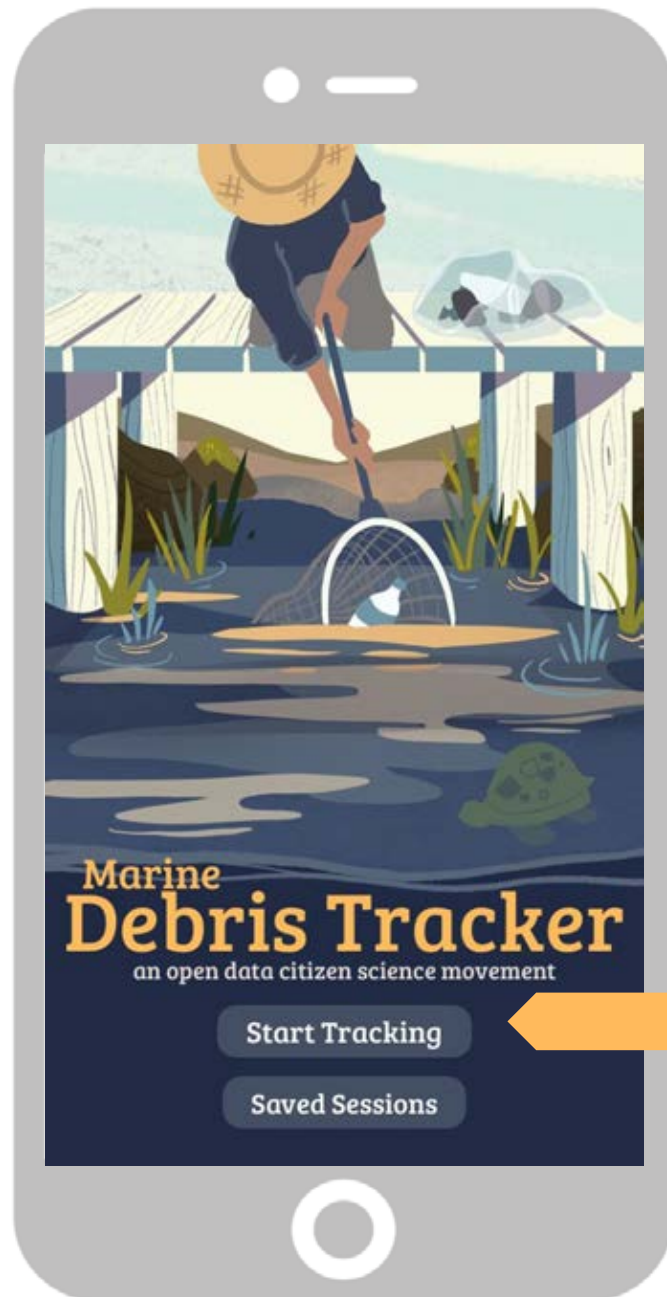

Then choose from one of 25+ lists based on your needs. If you're not associated with an organization, the NOAA list is a good place to start.

Hit the "Start Tracking" Button to begin a new session!







Scroll down to choose from 25+ lists in several different languages!

Foreign language options include:

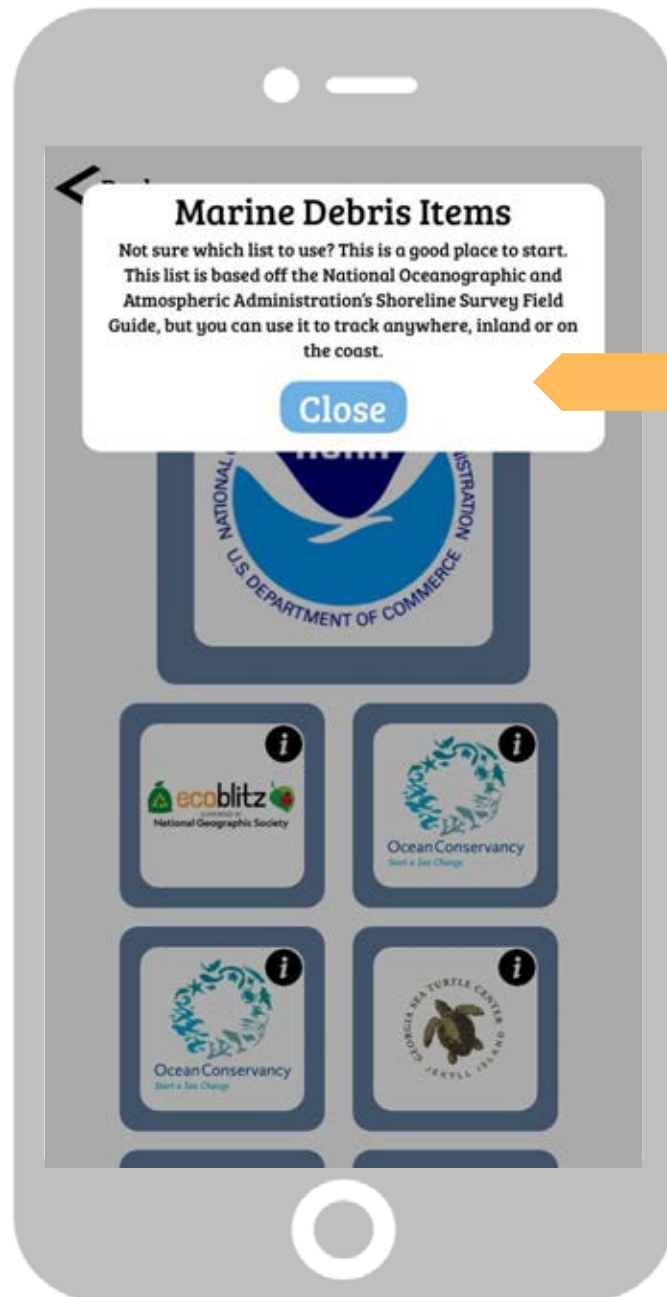
- **Spanish**, Ocean Conservancy's International Coastal Cleanup
- **Indonesian**, Indonesian Waste Platform
- **Albanian**, CRESSIDA
- **Hindi**, Wildlife Institute of India
- **Bengali**, WildTeam
- **Arabic**, Jordanian Royal Marine Conservation Society List
- **Russian**, Russian Waste Hub



Click the  or Info icon to learn more about a list

Click the list icon to open the list and see the Top Trackers. When you're ready, click "Use This List" to start tracking!

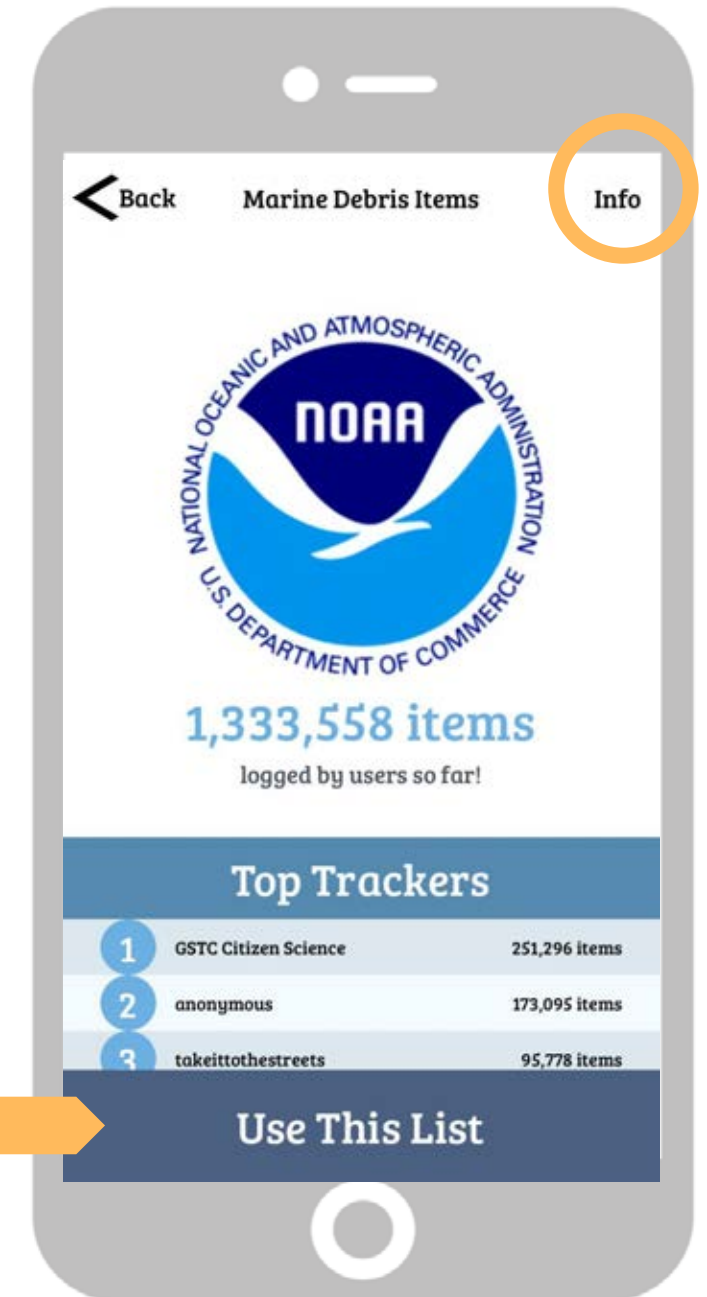

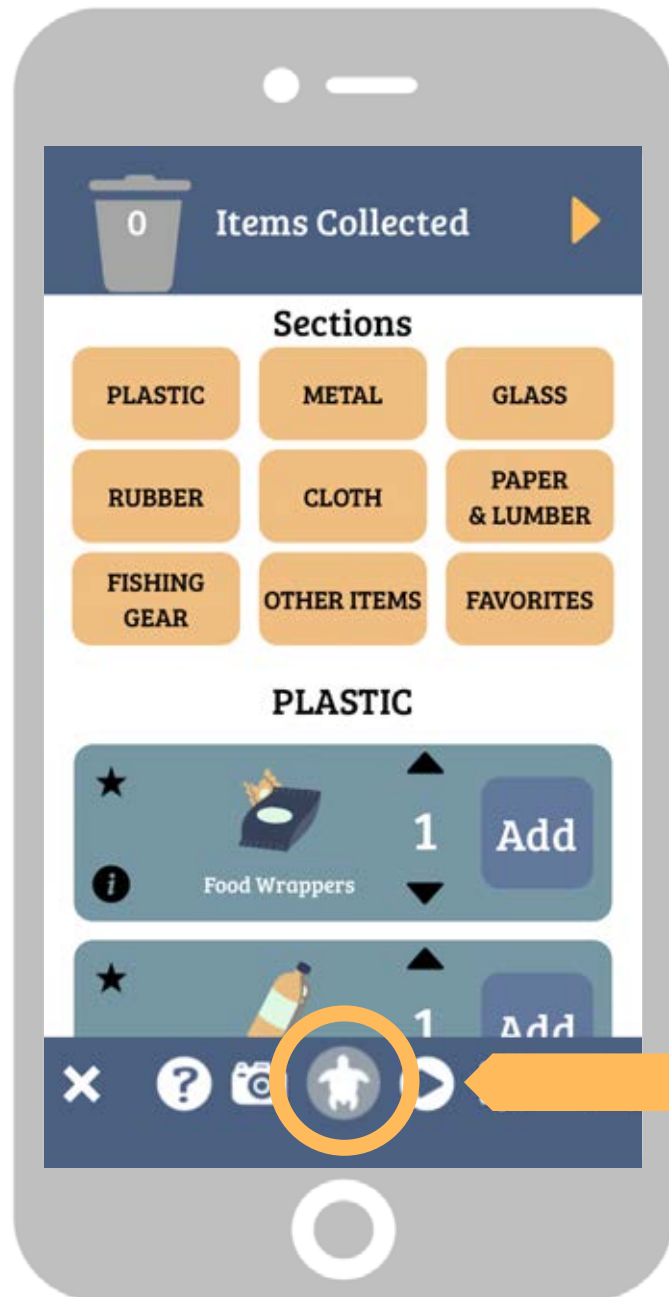

If you're new here, hit the "Sign Up" button to create a new account. Returning user? You can sign in with your email and password, or login through Facebook or SciStarter.

Once you've selected your list, hit the  to open the login page.

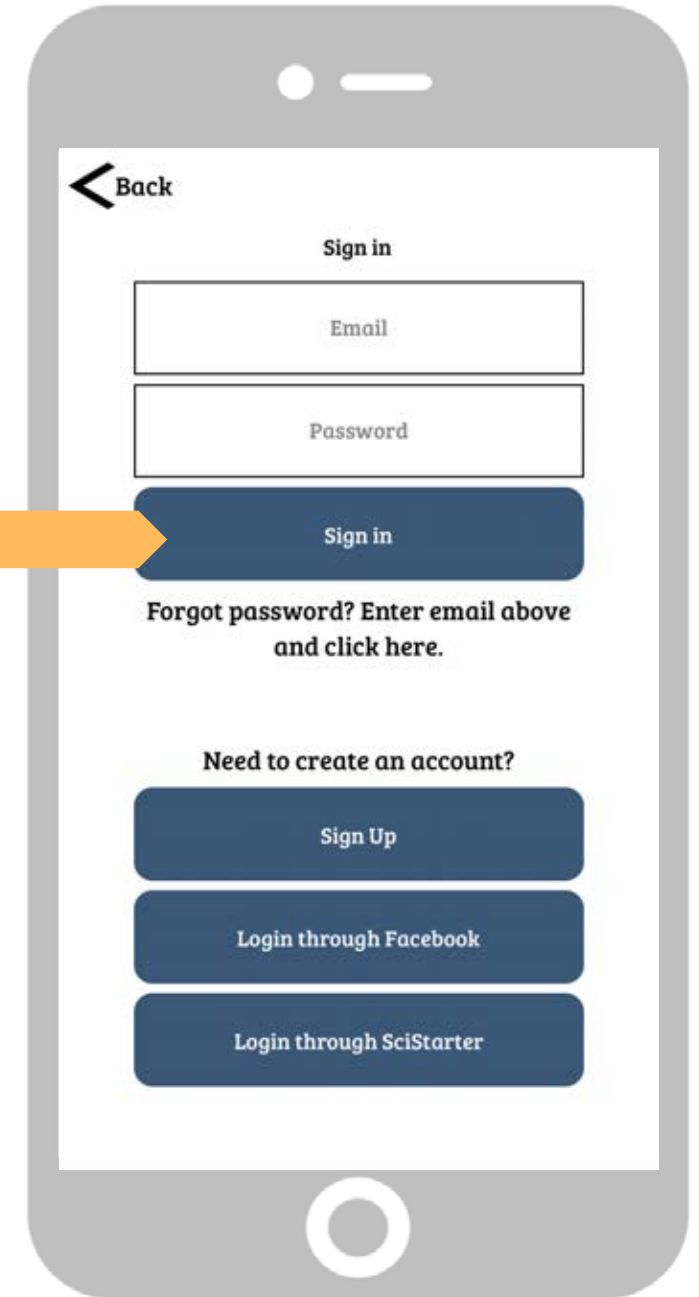

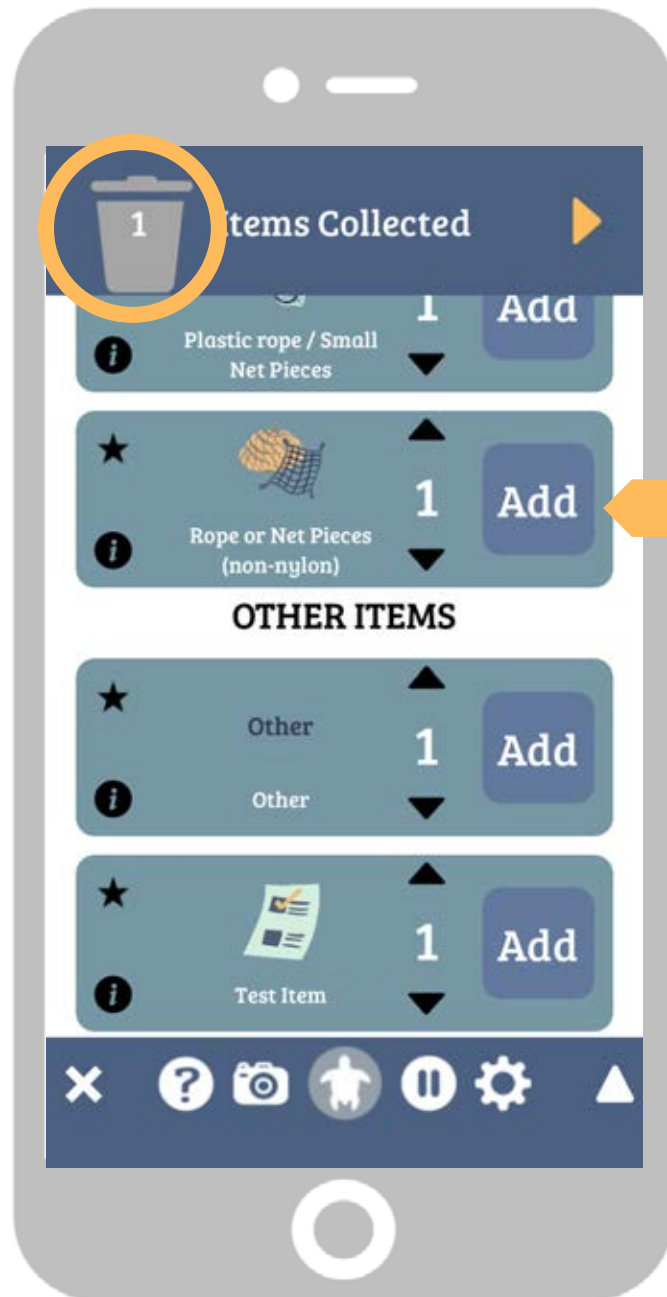

Just hit the “Add” button to add one of the item to your items collected!

More than one item? Use the up or down arrows to change the quantity before hitting “Add”. You can also hit the number to directly type in the quantity.

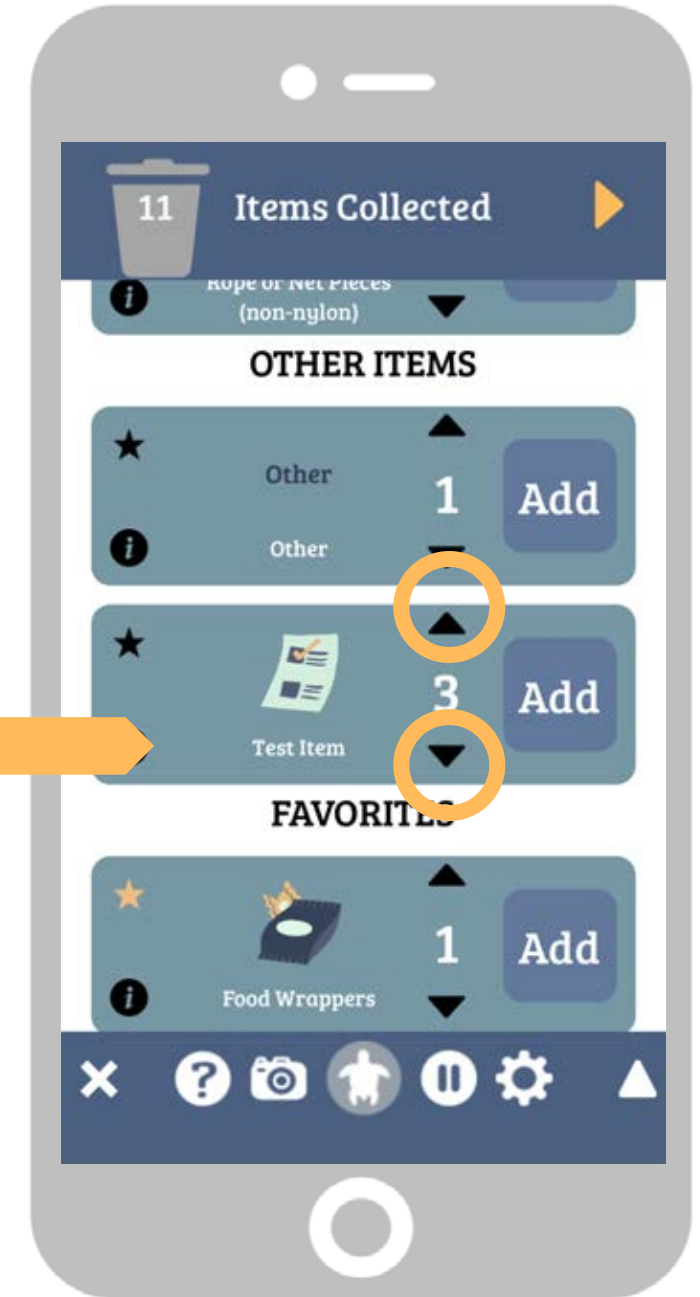

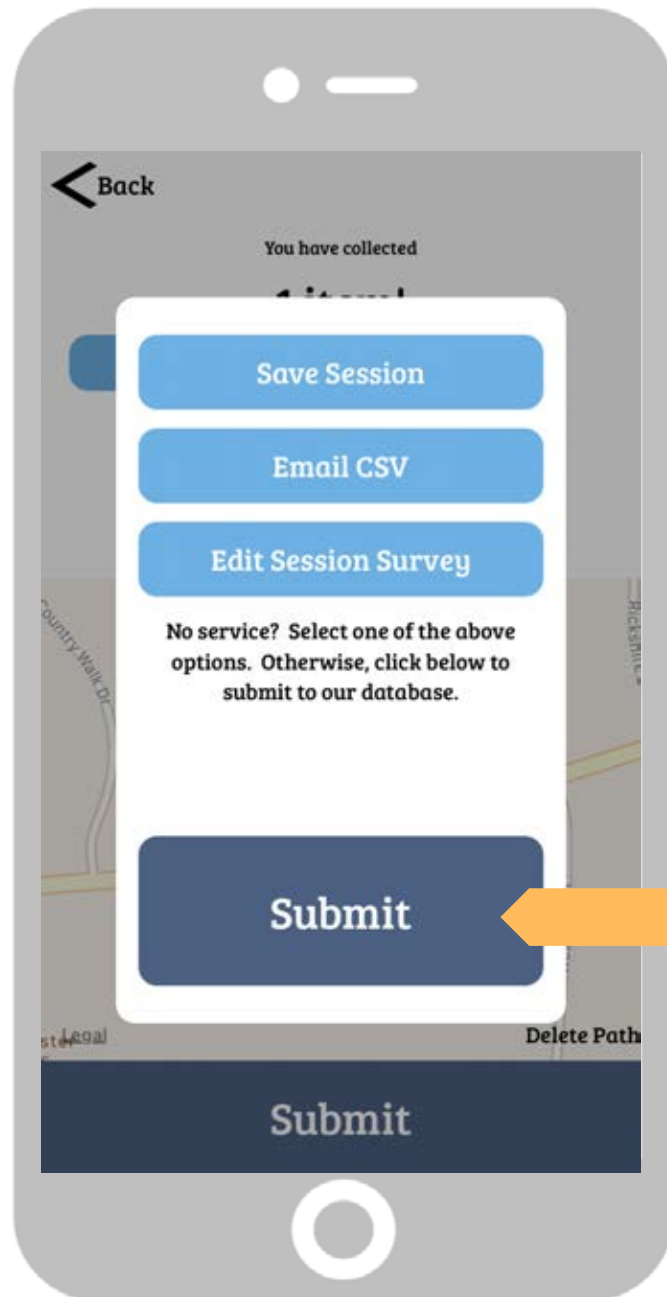

You're good to go! Share your tracking on social media to spread the word. Thank you for tracking!

You will be able to save your session for later, or email yourself a CSV. If you have access to Wi-Fi or data, you can go ahead and hit Submit to upload your data to our database!

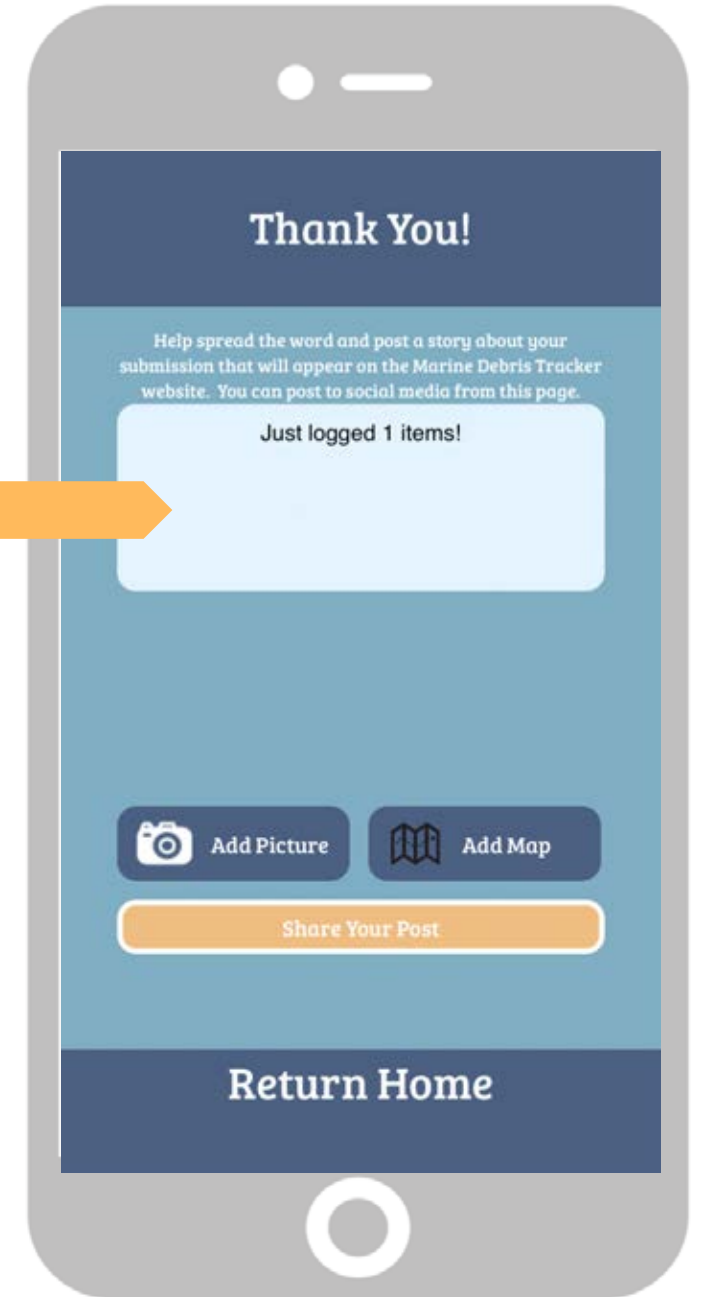



☐ All

☐ Exact

☒ Range

Distribution by Category

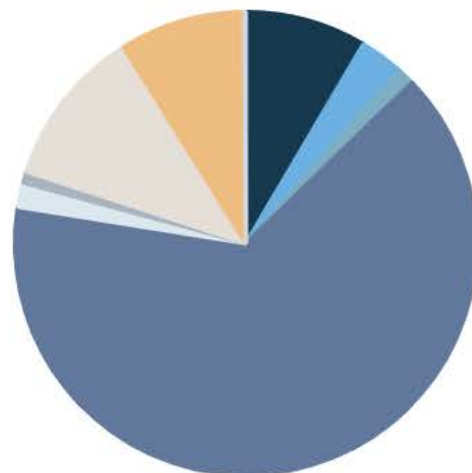
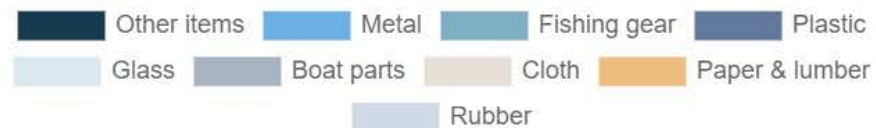

Top Items

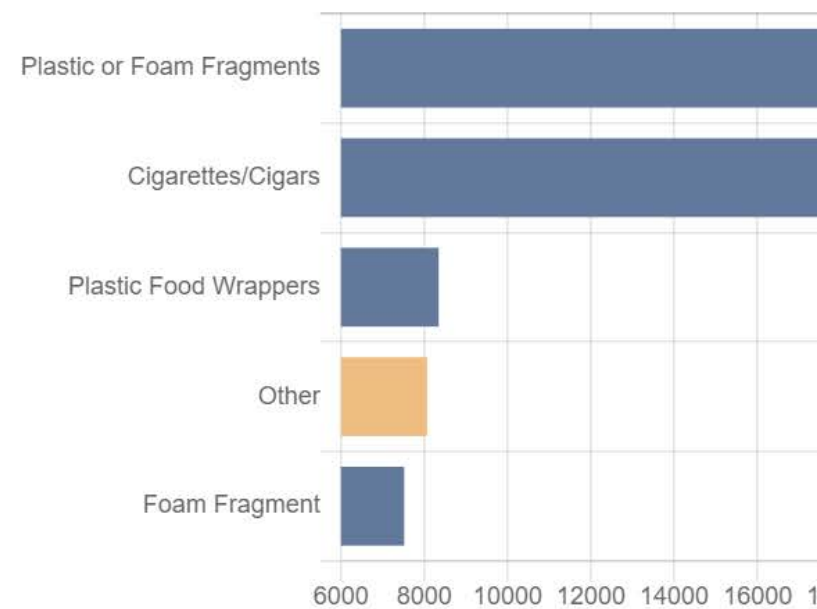

Case Studies



natgeo.org/debristracker

MOBILE APPLICATION GUIDE

Join our open data citizen science movement

Marine
Debris Tracker



Powered by:
Morgan Stanley

DEBRIS TRACKER

Want to help solve our planet's growing plastic pollution problem?

PLASTIC POLLUTION ACTION JOURNAL

NAME:

This six-step booklet is designed to help with thinking about our relationships to plastic and also plastic's relationship with our natural environment. Add your thoughts and ideas. Collect data, and analyze it. At the end, think about how we can all take action as individuals, and also together, locally to globally.

1

HOW IS PLASTIC PART OF MY LIFE?

Plastics are lightweight, durable, and long lasting. No wonder they are used for so many purposes in our daily lives. Think about how you use plastics:

I use these items...

... to do these things:



Plastic bag



Plastic bottle



Have you ever found plastic items to be a problem?
Explain...

3

USING SCIENCE TO UNDERSTAND THE PROBLEM

We know plastic pollution is a problem, but there's a lot we don't understand. Researchers from Bangladesh, India, U.S.A., and U.K. are working together as part of National Geographic's Sea to Source Expedition to try to answer these questions:

- How does plastic move from land to rivers and ultimately into the ocean?
- What are the most commonly littered plastics? Where do we find plastic littered on land?
- Are there microplastics in the air, water, and sediment near rivers?
- Why do people use plastic? What are the barriers to change?

What questions do you have about plastic?



DATA FOR RESEARCH

To help answer questions about common types of plastic, we are using an app called **Marine Debris Tracker (MDT)** to record the plastic we find in the environment.

You can help us track this litter. As you observe litter on land or in water with your school or community, use the Litter Tracking Sheet 4 to share your findings.

The data you collect can help us understand and the most commonly littered plastics and where we find them.

4

LITTER TRACKING SHEET

Working with a partner or group, keep track of plastic litter* found on land or in water by writing a tally mark for each item found in each category below.

	TOTAL
Plastic food wrappers	<input type="text"/>
Plastic bottles	<input type="text"/>
Plastic caps or lids	<input type="text"/>
Plastic bags	<input type="text"/>
Plastic straws	<input type="text"/>
Plastic utensils	<input type="text"/>
Foam or plastic cups or plates	<input type="text"/>
Personal care items	<input type="text"/>
Plastic string or tape	<input type="text"/>
Fishing rope or net pieces	<input type="text"/>
Hard plastic fragments	<input type="text"/>
Thin plastic fragments**	<input type="text"/>
Foam fragments	<input type="text"/>
Cigarettes	<input type="text"/>
Other	<input type="text"/>
Other	<input type="text"/>

Analyze this data in 5. You can also submit data via the Marine Debris Tracker (MDT) app. Thank you for contributing valuable data to scientific research.

TOTAL

*Data for non-plastic litter can also be added to MDT. Tally this data as "other" items. **Also called "plastic film."

Questions?



@DebrisTracker

debristracker101@gmail.com

Kathryn Youngblood,
kathryny@uga.edu

